

NOTES:

1. INSTALL CONTINUOUS CABLE FENCING FROM THE CAWD ACCESS ROAD, UNDER THE CAUSEWAY, ACROSS THE FLOODPLAIN BACK UNDER THE CAUSEWAY, AND UP THE SLOPE TO WHERE THE IMPROVED TRAIL ENDS, APPROX 1,940 LF. CONSTRUCT PER DETAILS 2 AND 4 ON THIS SHEET. CABLE FENCE IS SHOWN ON SHEET G-1.
2. SECTIONS OF EXISTING BARBED WIRE FENCE ALONG THE SOUTHERN GRADING LIMIT WILL NEED TO BE REMOVED DURING CONSTRUCTION. CONSTRUCT NEW BARBED WIRE FENCE (5-STRAND) WITH WOOD POSTS PER CALTRANS STANDARD PLANS A86 THROUGH A86D, TIED OFF TO REMAINING EXISTING FENCE. BARBED WIRE FENCING IS SHOWN ON SHEETS B-4, G-5, AND G-6.

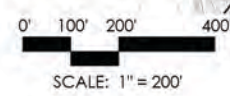
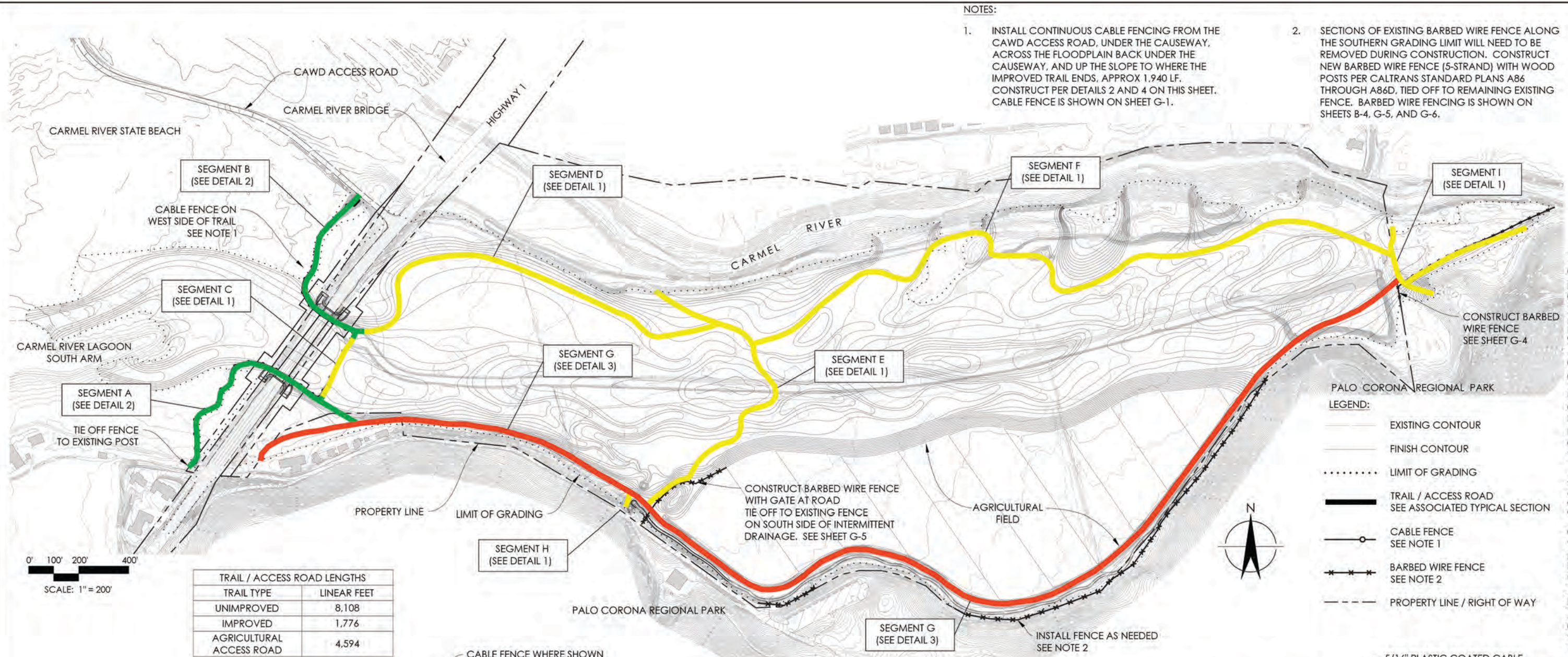

TRAIL / ACCESS ROAD LENGTHS	
TRAIL TYPE	LINEAR FEET
UNIMPROVED	8,108
IMPROVED	1,776
AGRICULTURAL ACCESS ROAD	4,594

- LEGEND:**
- EXISTING CONTOUR
 - FINISH CONTOUR
 - LIMIT OF GRADING
 - TRAIL / ACCESS ROAD
SEE ASSOCIATED TYPICAL SECTION
 - CABLE FENCE
SEE NOTE 1
 - x—x—x— BARBED WIRE FENCE
SEE NOTE 2
 - - - - - PROPERTY LINE / RIGHT OF WAY

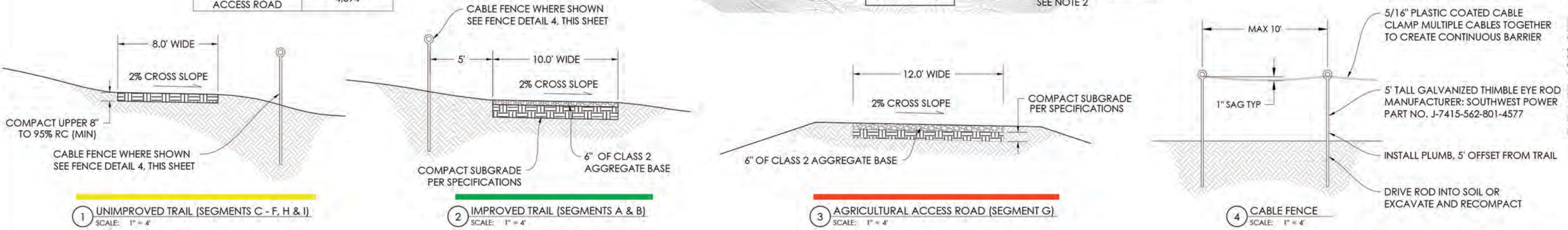

1 UNIMPROVED TRAIL (SEGMENTS C - F, H & I)
SCALE: 1" = 4'

2 IMPROVED TRAIL (SEGMENTS A & B)
SCALE: 1" = 4'

3 AGRICULTURAL ACCESS ROAD (SEGMENT G)
SCALE: 1" = 4'

4 CABLE FENCE
SCALE: 1" = 4'

DRAFT 60% SET - NOVEMBER 18, 2016 - NOT FOR CONSTRUCTION

Source: Balance Hydrologics Inc., November 2016